

# WX・LX SERIES

WXシリーズは、フラットベッド、高速・高性能両面飾り偏平縫いミシンです。

1本針のLXから4本針のモデル(WX8842-1)まで、偏平縫いからテープ付け、かぶせ縫い、レースゴム付け、テープ取り、ポケット向布付け、シェルスチックテープ付けなど応用範囲の広いシリーズです。プッシュボタン式送り調節機構により、容易に縫い目の長さを調節することができます(最大4mm、6針/インチ)。安定した縫い調子、伸びのある美しい縫い目からあらゆるニット、メリヤス製品に最適です。

WX series is flatbed, high speed, high performance with top and bottom cover stitch that have from 1 needle (LX) to 4 needle (WX8842-1), to be applied for any type of fabric and operation like plain stitch, covering, attaching elastic lace, taping, attaching pocket facing, shell stitching plus tape binding, and so on. Stitch length can be adjusted by push bottom easily (max. 4mm, 6 stitch/inch). This series is most suitable for knit fabrics in order to achieve uniform, flexible and beautiful stitch formation.

WX series maquina de cama plana, alta velocidad con recubridor arriba y abajo, desde una aguja, modelo LX hasta cuatro agujas, modelo WX8842-1 es posible usarlo en cualquier clase de telas y operaciones, tales como puntada regular, recubrir pegar cinta elastica, forros de bolcillo, puntada de concha y otras mas. El largo de puntada se regula facilmente aplicando precision al boton regulador(max.:4mm, 6 puntadas por pulgada). Esta serie produce una puntada bonita y uniforme en telas de punto.

WX 系列是平台式，高速、高性能两面绷缝的缝纫机。功能有一般装饰缝，滚领，花边松紧，滚条，裤袋的内衬布缝等广范围的系列缝纫机。通过按钮式调节，简易改变缝线迹长度<最大4mm, 6针 / 1英寸>安定的缝纫，美观的可伸缩的缝迹为针织最合适。

## WXシリーズ モデル表示方法

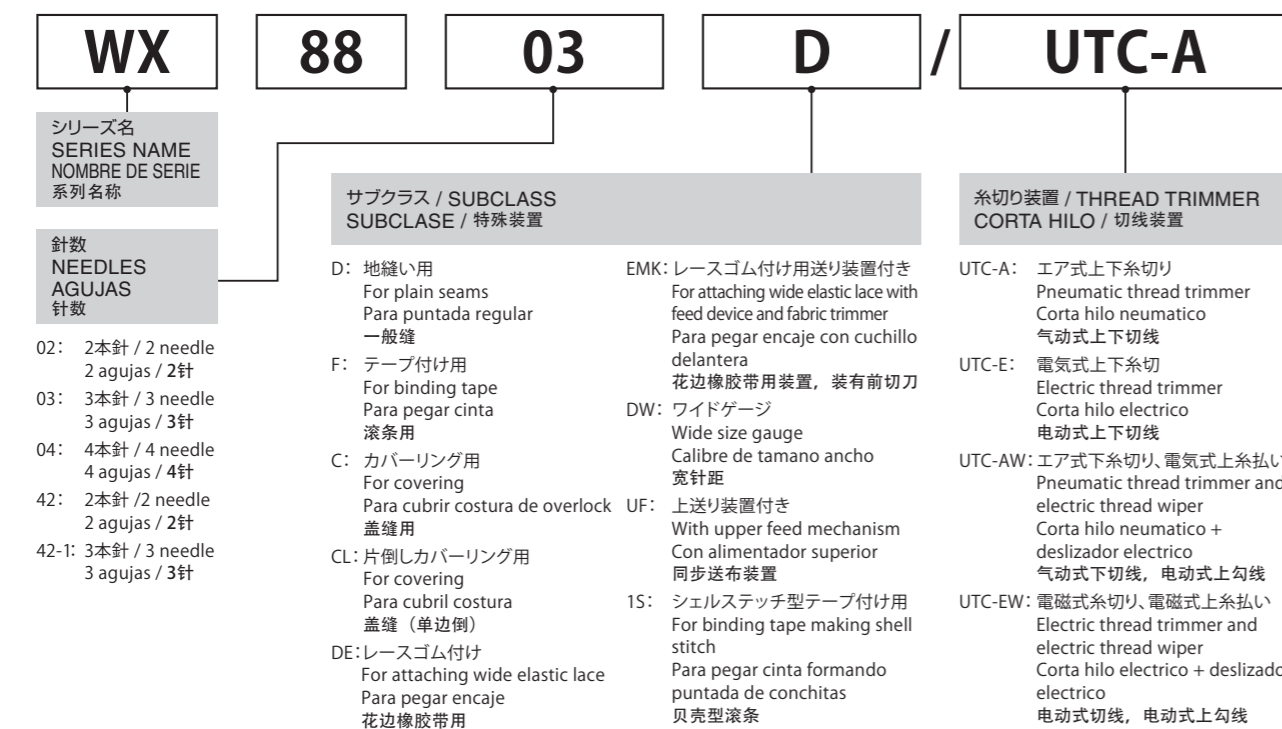

## LXシリーズ モデル表示方法

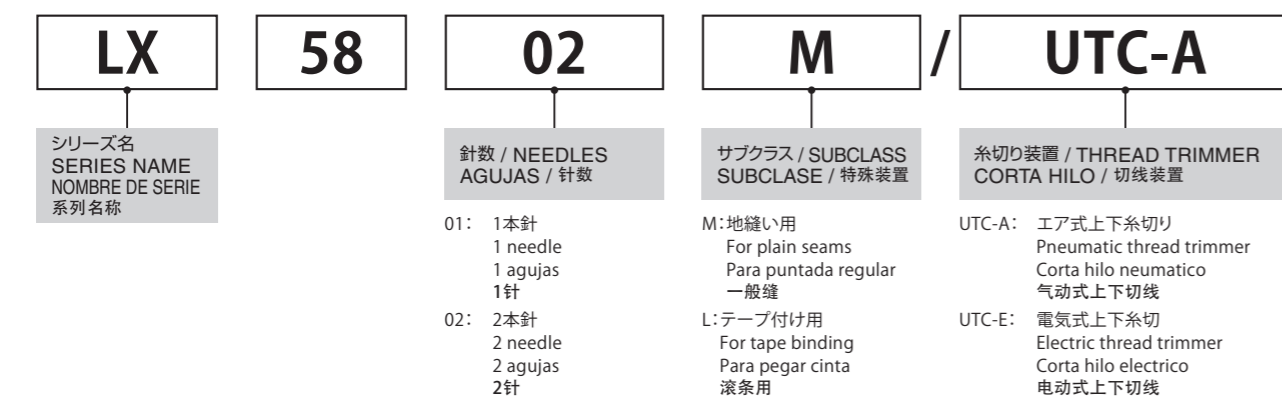

## WX8803D WX8803DW

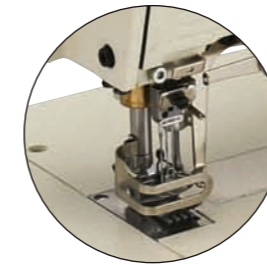

3本針両面飾り地縫いミシン

3 needle, flatbed, high speed, top and bottom cover stitch machine for plain seams.

3 agujas doble cadeneta con recubridor superior y inferior para puntada regular.

3 针两面装饰，平台式绷缝机

MODEL	No. of Needle	No. of Thread	Needle Type		Gauge (Inch)	No. of Stitch (Stitch/Inch)	Diff. Feed Ratio	Presser Foot Lift (mm)	Needle Bar Stroke (mm)	Max. Speed (rpm)
			Organ (#)	Schmetz (Nm)						
WX8802D	2	4	UYX128GAS 9~14	UYX128GAS 60~90	1/8, 5/32, 7/32, 1/4, 3/16	8~16	0.7~2	6	31	6000
WX8803D	3	5	UYX128GAS 9~14	UYX128GAS 60~90	7/32, 1/4, 3/16	8~16	0.7~2	6	31	6000
WX8803DW	3	5	UYX128GAS 9~14	UYX128GAS 60~90	7/32, 1/4	8~16	0.7~2	6	31	6000
* WX8802D/UTC-A/E WX8802D/UTC-AW/EW	2	4	UYX128GAS 9~14	UYX128GAS 60~90	1/8, 5/32, 7/32, 1/4, 3/16	8~16	0.7~2	6	31	6000
* WX8803D/UTC-A/E WX8803D/UTC-AW/EW	3	5	UYX128GAS 9~14	UYX128GAS 60~90	7/32, 1/4, 3/16	8~16	0.7~2	6	31	6000
* WX8803DW/UTC-A/E WX8803DW/UTC-AW/EW	3	5	UYX128GAS 9~14	UYX128GAS 60~90	7/32, 1/4	8~16	0.7~2	6	31	6000

## WX8803D-UF

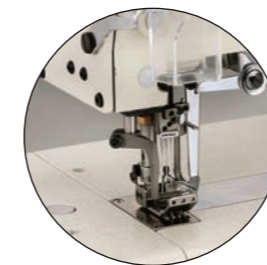

3本針両面飾り上下差動送り機構付きミシン

3 needle, flatbed, top and bottom cover stitch machine with upper feed mechanism.

3 agujas doble cadeneta con recubridor superior e inferior para puntada regular con alimentador superior.

3 针两面装饰，上下同步绷缝机

MODEL	No. of Needle	No. of Thread	Needle Type		Gauge (Inch)	No. of Stitch (Stitch/Inch)	Diff. Feed Ratio	Upper Feed Amount (mm)		Presser Foot Lift (mm)	Needle Bar Stroke (mm)	Max. Speed (rpm)
			Organ (#)	Schmetz (Nm)				←→	↑↓			
WX8802D-UF	2	4	UYX128GAS 9~14	UYX128GAS 60~90	3/16	8~16	0.7~2	1~7	3.5~6	6	33	5500
WX8803D-UF	3	5	UYX128GAS 9~14	UYX128GAS 60~90	7/32, 1/4, 3/16	8~16	0.7~2	1~7	3.5~6	6	33	5500
* WX8802D-UF/UTC-A/E WX8802D-UF/UTC-AW/EW	2	4	UYX128GAS 9~14	UYX128GAS 60~90	3/16	8~16	0.7~2	1~7	3.5~6	6	33	5500
* WX8803D-UF/UTC-A/E WX8803D-UF/UTC-AW/EW	3	5	UYX128GAS 9~14	UYX128GAS 60~90	7/32, 1/4, 3/16	8~16	0.7~2	1~7	3.5~6	6	33	5500

\* UTC-A/E -- UTC is available as A ( Air type-Pneumatic) or E ( Electric type) for machine with top cover stitch

\* UTC-AW/EW -- UTC is available as AW ( Air type wiper) or EW ( Electric type wiper) for machines without top cover stitch

### WX8803F

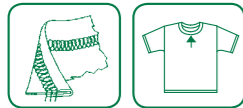

3本針両面飾りテープ付け用マシン  
3 needle, flatbed, high speed, top and bottom cover stitch machine for tape binding.  
3 agujas, para pegar cintas.  
3 针两面装饰平台式滚领缝机



MODEL	No. of Needle	No. of Thread	Needle Type		Gauge (Inch)	No. of Stitch (Stitch/Inch)	Diff. Feed Ratio	Presser Foot Lift (mm)	NeedleBar Stroke (mm)	Max. Speed (rpm)
			Organ (#)	Schmetz (Nm)						
WX8802F	2	4	UYX128GAS 9~14	UYX128GAS 60~90	1/8, 5/32, 7/32, 1/4, 3/16	8~16	0.7~2	6	31	6000
WX8803F	3	5	UYX128GAS 9~14	UYX128GAS 60~90	7/32, 1/4, 3/16	8~16	0.7~2	6	31	6000

### WX8803F-UF



3本針両面飾り上下差動送り付テープ付け用マシン  
3 needle, flatbed, high speed, top and bottom cover stitch machine for tape binding with upper feed mechanism.  
3 agujas con alimentador superior para pegar cinta.  
3 针两面装饰平台式上下同步滚领缝机



MODEL	No. of Needle	No. of Thread	Needle Type		Gauge (Inch)	No. of Stitch (Stitch/Inch)	Diff. Feed Ratio	Upper Feed Amount (mm)		Presser Foot Lift (mm)	NeedleBar Stroke (mm)	Max. Speed (rpm)
			Organ (#)	Schmetz (Nm)				←→	↑↓			
WX8802F-UF	2	4	UYX128GAS 9~14	UYX128GAS 60~90	1/8, 3/16	8~16	0.7~2	1~7	3.5~6	6	33	5500
WX8803F-UF	3	5	UYX128GAS 9~14	UYX128GAS 60~90	7/32, 1/4, 3/16	8~16	0.7~2	1~7	3.5~6	6	33	5500

### WX8803C WX8803CLW



WX8803CLW

MODEL	No. of Needle	No. of Thread	Needle Type		Gauge (Inch)	No. of Stitch (Stitch/Inch)	Diff. Feed Ratio	Presser Foot Lift (mm)	NeedleBar Stroke (mm)	Max. Speed (rpm)
			Organ (#)	Schmetz (Nm)						
WX8802C	2	4	UYX128GAS 9~14	UYX128GAS 60~90	3/16, 7/32, 1/4	8~16	0.7~2	6	31	6000
WX8803C	3	5	UYX128GAS 9~14	UYX128GAS 60~90	7/32, 1/4	8~16	0.7~2	6	31	6000
※ WX8802C/UTC-A/E WX8802C/UTC-AW/EW	2	4	UYX128GAS 9~14	UYX128GAS 60~90	3/16, 7/32, 1/4	8~16	0.7~2	6	31	6000
※ WX8803C/UTC-A/E WX8803C/UTC-AW/EW	3	5	UYX128GAS 9~14	UYX128GAS 60~90	7/32, 1/4	8~16	0.7~2	6	31	6000
WX8802CLW	2	4	UYX128GAS 9~14	UYX128GAS 60~90	3/16, 7/32, 1/4	8~16	0.7~2	6	31	6000
WX8803CLW	3	5	UYX128GAS 9~14	UYX128GAS 60~90	7/32, 1/4	8~16	0.7~2	6	31	6000
※ WX8802CLW/UTC-A/E WX8802CLW/UTC-AW/EW	2	4	UYX128GAS 9~14	UYX128GAS 60~90	3/16, 7/32, 1/4	8~16	0.7~2	6	31	6000
※ WX8803CLW/UTC-A/E WX8803CLW/UTC-AW/EW	3	5	UYX128GAS 9~14	UYX128GAS 60~90	7/32, 1/4	8~16	0.7~2	6	31	6000

※ UTC-A/E -- UTC is available as A ( Air type-Pneumatic) or E ( Electric type) for machine with top cover stitch  
※ UTC-AW/EW -- UTC is available as AW ( Air type wiper) or EW ( Electric type wiper) for machines without top cover stitch

### WX8803EMK

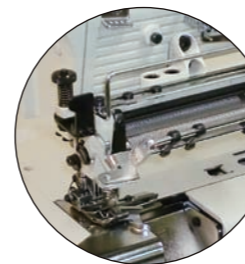

WX8803C

3本針両面飾り片倒しカバーリング用マシン  
3 needle, flatbed, high speed, top and bottom cover stitch machine for covering left fold of overlock seams.  
3 agujas, cama plana, recubridor superior e inferior para cubrir costura de over lock  
3 针两面装饰线迹包边缝线机 (单面倒盖缝)

3 针两面装饰线迹包边缝线机 (单面倒盖缝)



FRONT



BACK

MODEL	No. of Needle	No. of Thread	Needle Type		Gauge (Inch)	No. of Stitch (Stitch/Inch)	Diff. Feed Ratio	Presser Foot Lift (mm)	NeedleBar Stroke (mm)	Max. Speed (rpm)
			Organ (#)	Schmetz (Nm)						
WX8802EMK	2	4	UYX128GAS 9~14	UYX128GAS 60~90	3/16, 7/32, 1/4	8~16	0.7~2	5	31	5000
WX8803EMK	3	5	UYX128GAS 9~14	UYX128GAS 60~90	3/16, 7/32, 1/4	8~16	0.7~2	5	31	5000

3本針両面飾り前メス付ゴム送り装置付マシン  
3 needle, flatbed, top and bottom cover stitch machine with a fabric trimmer and elastic feeding mechanism for attaching elastic lace.  
3 agujas, recubridor superior e inferior con cuchillo al frente y dosificador de elastico superior, con mecanismo para pegar encajes.  
3 针两面装饰线迹缝线机 (带前切刀, 上松紧带用装置)

3 针两面装饰线迹缝线机 (带前切刀, 上松紧带用装置)

3 针两面装饰线迹缝线机 (带前切刀, 上松紧带用装置)

3 针两面装饰线迹缝线机 (带前切刀, 上松紧带用装置)

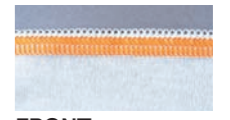

FRONT



BACK

MODEL	No. of Needle	No. of Thread	Needle Type		Gauge (Inch)	No. of Stitch (Stitch/Inch)	Diff. Feed Ratio	Presser Foot Lift (mm)	NeedleBar Stroke (mm)	Max. Speed (rpm)
			Organ (#)	Schmetz (Nm)						
WX8802EMK	2	4	UYX128GAS 9~14	UYX128GAS 60~90	3/16, 7/32, 1/4	8~16	0.7~2	5	31	5000
WX8803EMK	3	5	UYX128GAS 9~14	UYX128GAS 60~90	3/16, 7/32, 1/4	8~16	0.7~2	5	31	5000

# WX8842 WX8842-1



FRONT

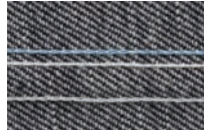

BACK



WX8842-1

ポケット向当布付用3本針上飾り縫いミシン安全縫い二重環付のため強度面で優れています。

3 needle, flatbed, top cover stitch machine with safety stitch for attaching pocket facings. Double chain stitch produces durable seams.

3 agujas doble cadeneta con recubridor superior, para pegar forros de bolsillo.

< WX8842 >  
3针双重环缝，2针有上装饰缝兜用缝纫机  
< WX8842-1 >  
3针上面装饰，缝装兜用缝纫机

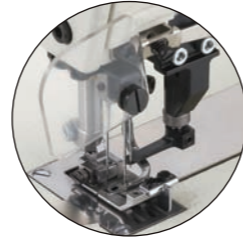

WX8842-1

MODEL	No. of Needle	No. of Thread	Needle Type		Gauge (Inch)	No. of Stitch (Stitch/Inch)	Diff. Feed Ratio	Presser Foot Lift (mm)	Needle Bar Stroke (mm)	Max. Speed (rpm)
			Organ (#)	Schmetz (Nm)						
WX8842	2	5	UYX128GAS 9~14	UYX128GAS 60~90	6.4mm	7~16	0.7~2	4.5	31	5000
WX8842-1	3	7	UYX128GAS 9~14	UYX128GAS 60~90	2.4mm x 6.4mm	7~16	0.7~2	4.5	31	5000

# WX8803-1S

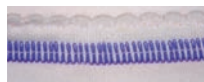

FRONT 4:1

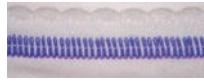

FRONT 5:1



FRONT 6:1



BACK



4本針両面飾り縫いシェルステッチテープ取りミシン(2~4本までの下記表のゲージの種類があります。)また、新モデルではシェルの幅を3段階で調節できます

4 needle, flatbed, top and bottom cover stitch machine for the shell (scallop) stitching with tape binding. 3 kinds of the shell (scallop) sizes such as small, medium and big are adjustable.

3 y 1 agujas, recubridor superior e inferior, 1 aguja con doble, cadeneta, formando puntada decorativa de conchitas

4针两面装饰线迹，贝壳缝缀胶带(有2到4针的针位种类)还可以贝壳缝的距离调整3段



MODEL	No. of Needle	No. of Thread	Needle Type		Gauge (Inch)	No. of Stitch (Stitch/Inch)	Diff. Feed Ratio	Presser Foot Lift (mm)	Needle Bar Stroke (mm)	Max. Speed (rpm)
			Organ (#)	Schmetz (Nm)						
WX8802-1S	3	6	UYX128GAS 9~14	UYX128GAS 60~90	3.5mmX4mm	8~16	0.7~2	6	31	4500
WX8803-1S	4	7	UYX128GAS 9~14	UYX128GAS 60~90	7/32 x 4mm	8~16	0.7~2	6	31	4500

# WX8804D



4本針両面飾り縫いミシンプリーフの股継ぎなどフラットシーマの代わりとしてお使い頂けます。

4 needle, flatbed, top and bottom cover stitch machine for joining the crotch of briefs, instead of flat seamer.

4 agujas, cama plana, recubridor superior e inferior para unir costuras.

4针两面装饰，平台式绷缝机

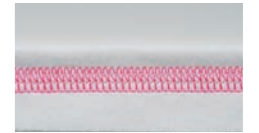

FRONT



BACK

MODEL	No. of Needle	No. of Thread	Needle Type		Gauge (Inch)	No. of Stitch (Stitch/Inch)	Diff. Feed Ratio	Presser Foot Lift (mm)	Needle Bar Stroke (mm)	Max. Speed (rpm)
			Organ (#)	Schmetz (Nm)						
WX8804D	4	6	SM1014H 10S		6mm, 6.4mm	8~16	0.7~2	6	30	4000
WX8804D/UTC-A/E	4	6	SM1014H 10S		6mm, 6.4mm	8~16	0.7~2	6	30	4000

# LX5802LR

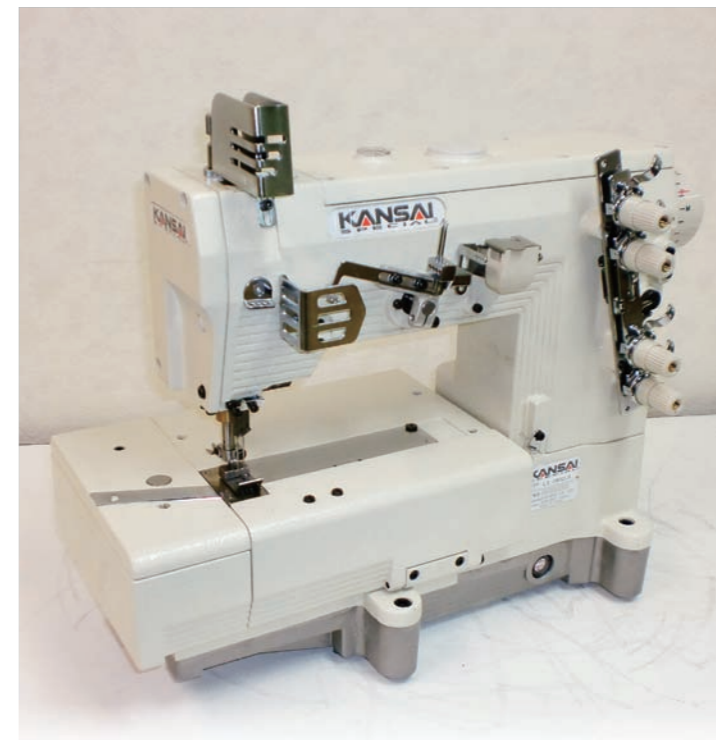
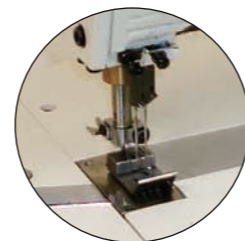

2本針二重環縫い、フラットベッド、ラップシーム用押え付きミシン

2 needle, flatbed, double chain stitch machine for lap seam with original presser foot.

2 agujas, flatbed, la maquina de puntada de cadena doble para la costura del regazo con pie del presser original.

2针双重环缝，平台式埋夹缝纫机(另外配备反向埋夹缝压脚。)

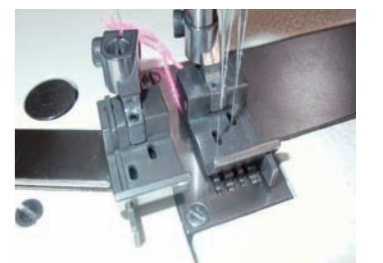

MODEL	No. of Needle	No. of Thread	Needle Type		Gauge (Inch)	No. of Stitch (Stitch/Inch)	Diff. Feed Ratio	Presser Foot Lift (mm)	Needle Bar Stroke (mm)	Max. Speed (rpm)
			Organ (#)	Schmetz (Nm)						
LX5802LR	2	4	UY128 GAS #16	UYX128 GAS 100	6.4mm	6.5~1.6		8	33	6000

### LX5802L



2本針二重環縫いテープ付マシン  
 2 needle, flatbed, double chain stitch machine for attaching line tapes.  
 2 agujas doble cadeneta; cama plana, para pegar cintas.  
 2 针双重环缝，平台式滚领缝切机



MODEL	No. of Needle	No. of Thread	Needle Type		Gauge (Inch)	No. of Stitch (Stitch/Inch)	Diff. Feed Ratio	Presser Foot Lift (mm)	Needle Bar Stroke (mm)	Max. Speed (rpm)
			Organ (#)	Schmetz (Nm)						
LX5802L	2	4	UYX128GAS 9~14	UYX128GAS 60~90	3/16, 1/4, 3/8	8~16	0.7~2	8	31	6000
LX5802M	2	4	UYX128GAS 9~14	UYX128GAS 60~90	3/16, 1/4, 3/8	8~16	0.7~2	8	31	6000

### LX5802TMF



FRONT



BACK



2本針二重環縫い、タンデム針ゲージ、マジック押え付マシン  
 (特殊押えにより空環をきれいにすることが出来ます。)  
 2 needle (tandem needles), flatbed, double chain stitch machine with 'Magic Presser Foot'. (chain off can be made by the magic foot)  
 2 agujas (agujas tandem) doble cadeneta (agujas en linea), cama plana.  
 2 针双重环缝，平台式缝纫机 (0 针位)

MODEL	No. of Needle	No. of Thread	Needle Type		Gauge (Inch)	No. of Stitch (Stitch/Inch)	Diff. Feed Ratio	Presser Foot Lift (mm)	Needle Bar Stroke (mm)	Max. Speed (rpm)
			Organ (#)	Schmetz (Nm)						
LX5802MF	2	4	UYX128GAS 9~14	UYX128GAS 60~90	2.4mm	8~16	0.7~2	8	31	6000
LX5802TMF	2	4	UYX128GAS 9~14	UYX128GAS 60~90	1/64(0.4mm)	8~16	0.7~2	8	31	6000

### LX5803PHD



### INDUSTRIAL SEWING MACHINES PRODUCTS GUIDE

3本針フラットベッド二重環縫いラップシーム用マシン。同梱パーツにより、逆タコ巻き縫い、1本針端縫いが可能です。  
 3 needle, flatbed, double chain stitch machine for lap seaming. Includes the parts for opposite lap seaming and edge seaming.  
 3 agujas, cama plana, máquina de doble cadeneta para costura de cerrar. Includido las piezas de cerradora de lado inverso, y costura de borde.  
 3 针双重环缝，平台式包边缝切机

### 3 Operations in 1 machine / 3 funcionamiento en 1 maquina / 3 针双重环缝，平台式包边缝切机

#### 1 タコ巻き縫い / LAP SEAM Cerradora / 埋夹缝

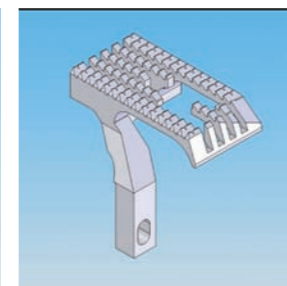
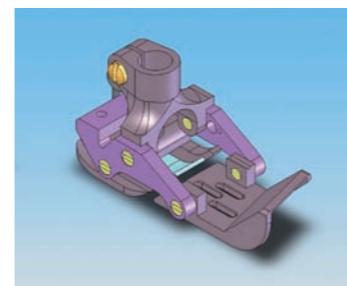

#### 2 逆タコ巻き縫い(同梱品) / LAP SEAM IN OPPOSITE SIDE Cerradora de lado inverso / 反向埋夹缝

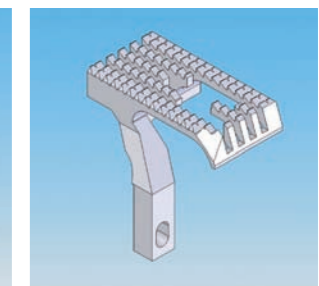
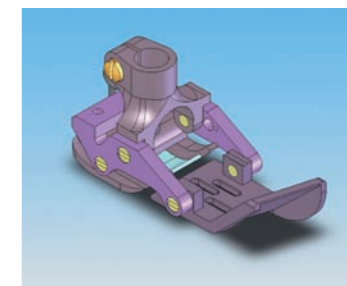

#### 3 1本針端縫い用押え(同梱品) / Presser foot for closing the side stitch Pie para costura de borde / 1针缝端部用的压脚

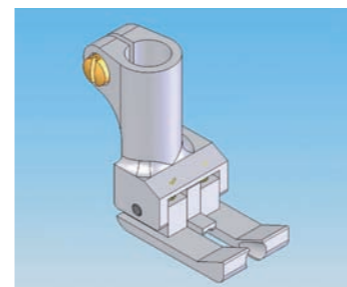

MODEL	No. of Needle	No. of Thread	Needle Type		Gauge (Inch)	No. of Stitch (Stitch/Inch)	Diff. Feed Ratio	Presser Foot Lift (mm)	Needle Bar Stroke (mm)	Max. Speed (rpm)
			Organ (#)	Schmetz (Nm)						
LX5803PHD	3	6	TVX5 18		1/2", 1/4", 3/8"	6~12	1枚送り	8	34	4500

LX5801SP

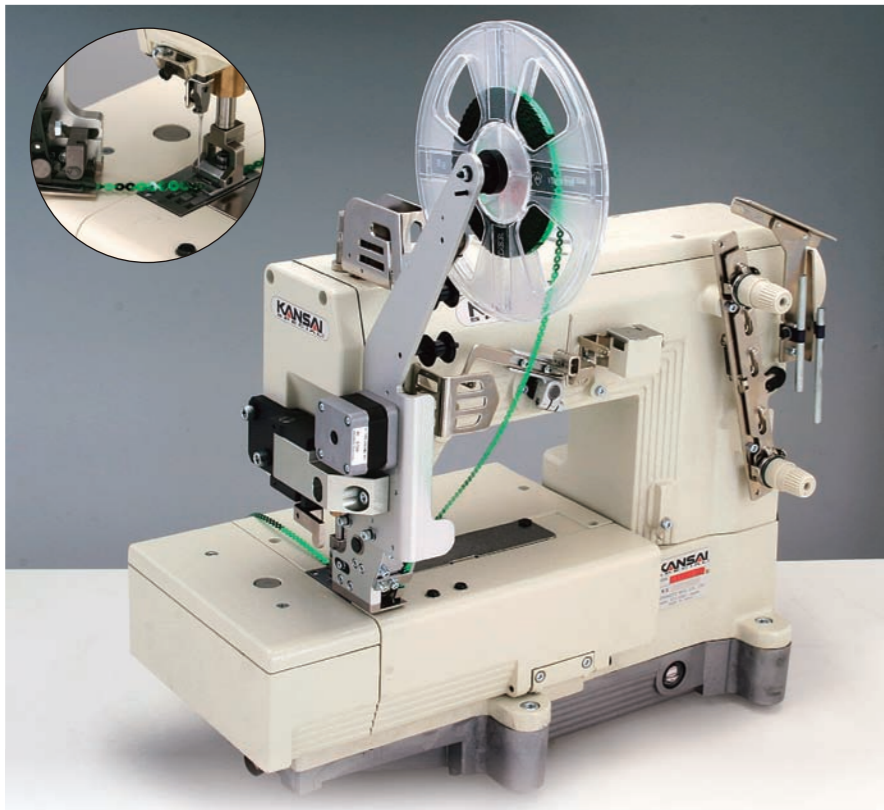

1本針二重環縫いスパンコール送り出し装置付ミシン  
シークインのピッチ(送り量)およびスキップ(1針毎から  
10針毎に1回のシークインのスキップ縫い間隔)はパ  
ルスモーター制御により操作パネルの設定で変更可能  
です。ガイドを換えることで3.5,7mmのサイズのスバ  
ンコールを使用できます。最高回転:1000rpm

1needle, flatbed, double chain stitch machine for attaching sequins by sequin device. Sequin size and skip timing (1 sequin every 1stitch to 10 stitches) can be changed by control box.. Three sizes of sequin 3, 5, and 7 mm are available by changing the optional guide and pressure foot.

1 agulha, base plana, maquina de ponto cadeia duplo para aplicacao de cequins decorativas atraves de um dispositivo pula pontos. O volume da alimentacao do dispositivo e a sincronia do pula ponto (A cada uma lantejola 1 ponto para 10 pontos) podem ser mudados atraves de uma operacao no painel. Tres tamanhos de lantejola podem ser usadas depois da troca da guia do dispositivo pula ponto as de 3, 5, e de 7 mm. Velocidade maxima: 1000 rpm

1 针双重环缝，带送装饰亮片用装置式缝纫机。通过电子操作控制箱的操作设定可以改变装饰亮片间的缝制距离（装饰亮片之间的缝制距离从1针距到10针距之间的任何距离）通过更换卡具可以缝3、5、7mm尺寸的装饰亮片  
最高转速：1000rpm

■ 操作パネルによる簡単な操作 / Easy setting operation panel

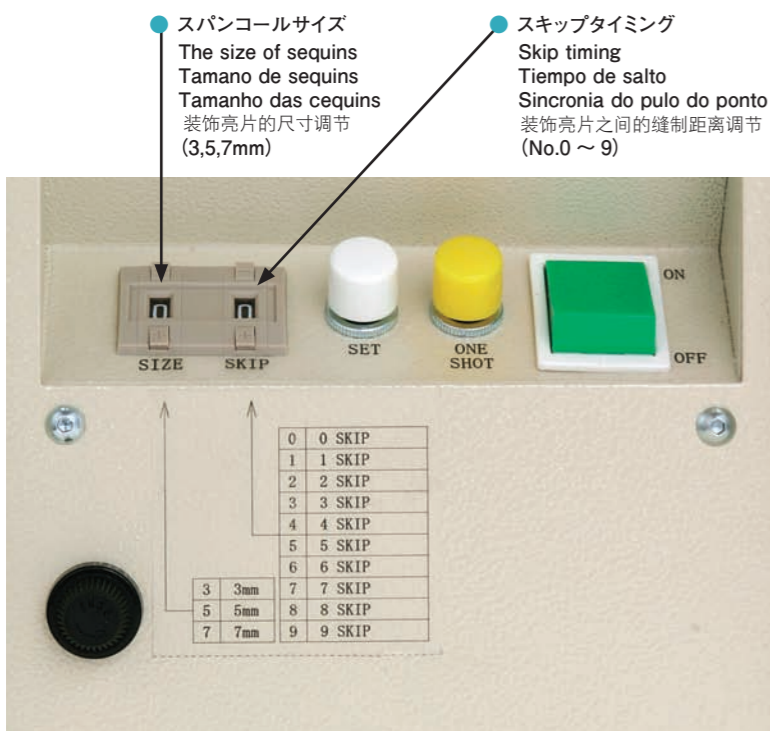

スキップタイミング /  
Skip timing / Tiempo de salto /  
Sincronia do pula ponto / 缝制样片



No.0 連続付け  
1 sequin every stitch  
1 cequi cada puntada  
1 enfeite a cada ponto  
1 针间距的缝制样片



No.1 2 ステッチに付き 1 スパンコール  
1 sequin every 2 stitches  
1 cequi cada 2 puntadas  
1 enfeite a cada 2 pontos  
2 针间距的缝制样片



No.2 3 ステッチに付き 1 スパンコール  
1 sequin every 3 stitches  
1 cequi cada 3 puntadas  
1 enfeite a cada 3 pontos  
3 针间距的缝制样片

WX OTHER SERIES | TECHNICAL DATA 仕様詳細

MODEL	No. of Needle	No. of Thread	Needle Type		Gauge(Inch)	No. of Stitch (Stitch/Inch)	Diff. Feed Ratio	Upper Feed Amount (mm)		Presser Foot Lift (mm)	NeedleBar Stroke (mm)	Max. Speed (rpm)
			Organ (#)	Schmetz (Nm)				←→	↑↓			
WX8803-DE	3	5	UYX128GAS 9~14	UYX128GAS 60~90	7/32, 1/4	8~16	0.7~2			6	31	6000
WX8802A-UF	2	4	UYX128GAS 9~14	UYX128GAS 60~90	3/16	8~16	0.7~2	1~7	3.5~6	6	33	5500
WX8803A-UF	3	5	UYX128GAS 9~14	UYX128GAS 60~90	7/32, 1/4	8~16	0.7~2	1~7	3.5~6	6	33	5500
WX8803AH-UF	3	5	UYX128GAS 18		1/4	6		1~7	3.5~6	6	33	5000

LX OTHER SERIES | TECHNICAL DATA 仕様詳細

MODEL	No. of Needle	No. of Thread	Needle Type		Gauge(Inch)	No. of Stitch (Stitch/Inch)	Diff. Feed Ratio	Upper Feed Amount (mm)		Presser Foot Lift (mm)	NeedleBar Stroke (mm)	Max. Speed (rpm)
			Organ (#)	Schmetz (Nm)				←→	↑↓			
LX5801	1	2	UYX128GAS 9~14	UYX128GAS 60~90		8~16	0.7~2			8	31	6000
LX5801-UTC-A	1	2	UYX128GAS 9~14	UYX128GAS 60~90		8~16	0.7~2			8	31	6000
LX5801-UTC-AB	1	2	UYX128GAS 9~14	UYX128GAS 60~90		8~16	0.7~2			8	31	6000
LX5801-UTC-E	1	2	UYX128GAS 9~14	UYX128GAS 60~90		8~16	0.7~2			8	31	6000
LX5802M	2	4	UYX128GAS 9~14	UYX128GAS 60~90	1/4 (6.4mm)	8~16	0.7~2			8	31	6000

MODEL	No. of Needle	No. of Thread	Needle Type		Gauge (Inch)	No. of Stitch (Stitch/Inch)	Diff. Feed Ratio	Presser Foot Lift (mm)	NeedleBar Stroke (mm)	Max. Speed (rpm)
			Organ (#)	Schmetz (Nm)						
LX5801SP	1	2	UYX128GAS 9~14	UYX128GAS 60~90	—	8~16	0.7~2	8	31	1000